

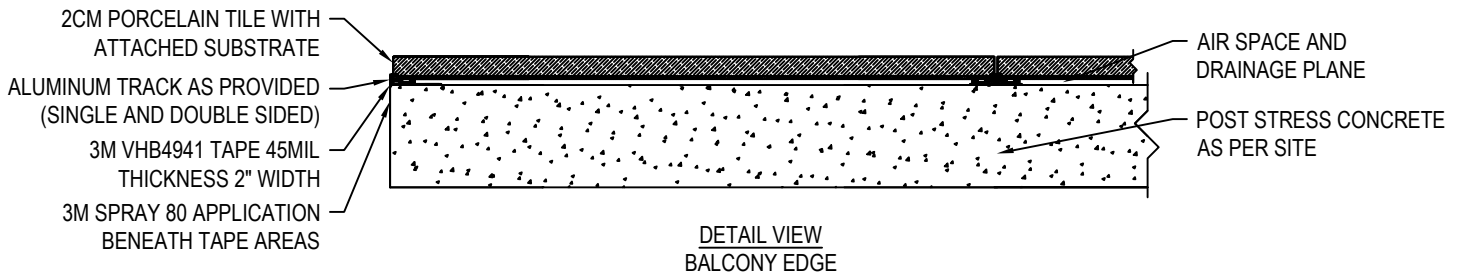

# MBRICO

MBRICO TILE DECKS  
P.O. BOX 1108  
BETTENDORF, IA 52722  
TOLL FREE: 1-844-449-9214  
www.mbricotiledecks.com

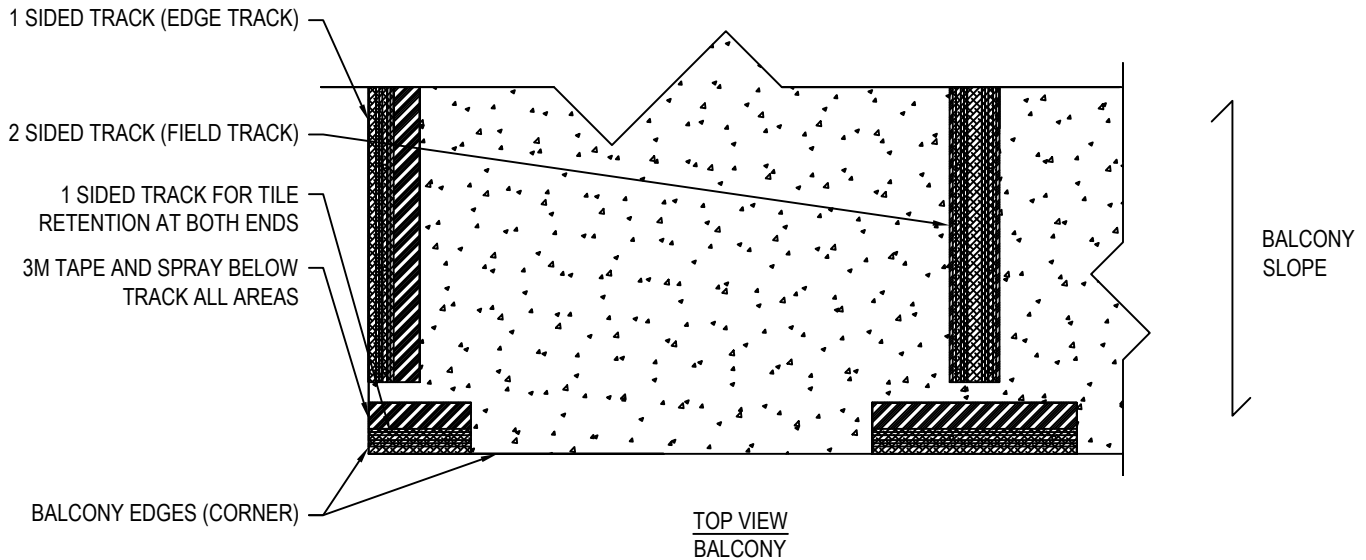

#### MANUFACTURE NOTES:

##### TOP VIEW - BALCONY

- CORNER AND FIELD SECTION DRAWN, APPLICABLE TO ALL CORNERS.
- CLEARANCES FROM FLASHINGS AND WALLS DETERMINED ON SITE.
- TRACK PROVIDED AT 12' LENGTHS.

##### DETAIL VIEW - BALCONY EDGE

- PROVIDED TRACK TO BE INSTALLED SAME DIRECTION AS BALCONY SLOPE
- 3M TAPE AND SPRAY APPLIED PER 3M SPECIFICATION
- TILES FIELD CUT AND RESLOTTED WHERE NECESSARY
- ONSITE BALCONY RAILING VIEWED WAS SIDE MOUNTED TO POST STRESS CONCRETE.

#### NOTES:

1. INSTALLATION TO BE COMPLETED IN ACCORDANCE WITH MANUFACTURER'S SPECIFICATIONS.
2. DO NOT SCALE DRAWING.
3. THIS DRAWING IS INTENDED FOR USE BY ARCHITECTS, ENGINEERS, CONTRACTORS, CONSULTANTS AND DESIGN PROFESSIONALS FOR PLANNING PURPOSES ONLY. THIS DRAWING MAY NOT BE USED FOR CONSTRUCTION.
4. ALL INFORMATION CONTAINED HEREIN WAS CURRENT AT THE TIME OF DEVELOPMENT BUT MUST BE REVIEWED AND APPROVED BY THE PRODUCT MANUFACTURER TO BE CONSIDERED ACCURATE.
5. CONTRACTOR'S NOTE: FOR PRODUCT AND COMPANY INFORMATION VISIT [www.CADdetails.com/info](http://www.CADdetails.com/info) AND ENTER REFERENCE NUMBER 5279-010

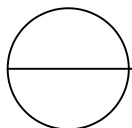

## MBRICO DETAILS

MBRICO: VENTILATED OVER CONCRETE LO-PRO